

A close-up photograph of several purple flowers, likely hydrangeas, in various stages of bloom. The flowers are the central focus, with some in sharp focus and others blurred in the background. The petals are a vibrant purple color, and the green stems and leaves are visible. The background is a soft, out-of-focus white and light purple.

A LUXURY DEVELOPMENT OF 28 STONE BUILT HOMES

Standroyd Court

Keighley Road, Colne



Standroyd Court is a luxury development of 28 stone built homes only 3 minutes drive from Colne town centre. It is set in the moorlands of Lancashire's Hill Country. Wycoller Country Park and Boulsworth Hill are both within walking distance.



Standroyd Court

Keighley Road, Colne

Beautifully designed homes in superb surroundings. There are three styles of homes, the Standroyd, the Horsefield and the Boulsworth.

SPECIFICATIONS

- Natural stone under a natural slate roof
- Gas central heating with efficient condensing boiler
- Light oak UVPC double glazed windows including French doors
- Choice of fully fitted kitchens and worktops including fully integrated SMEG appliances
- Chrome downlighters fitted to bathrooms and en-suite
- White Roca Bathroom suites with chrome fittings and bath screen
- Ceiling coving to lounge/dining room
- Moulded skirting and architraves throughout
- Panelled interior doors with chrome ironmongery
- Burglar alarms and smoke detectors fitted
- External lighting to front and rear
- Remote controlled garage doors
- Woodwork, ceiling and coving painted white
- Walls painted white throughout
- Multiple TV points
- Pathways and patio areas finished with Riven paving flags
- NHBC 10 year guarantee
- All properties are freehold
- Brushed steel downlighters to kitchen/dining area
- Ladder style chrome towel rails to bathrooms



Boulsworth

Houses

2, 6, 12, 17, 19, & 26 on site plan

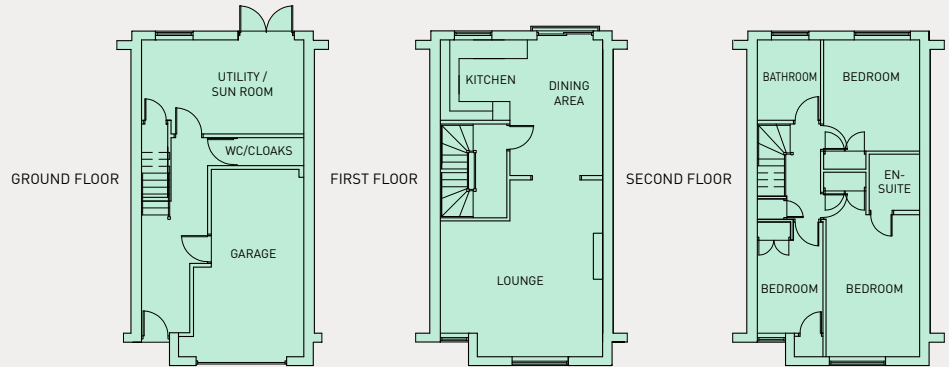

Standroyd

Houses

5, 7, 10, 11, 13, 14, 16, 21, 22, 25 & 27 on site plan

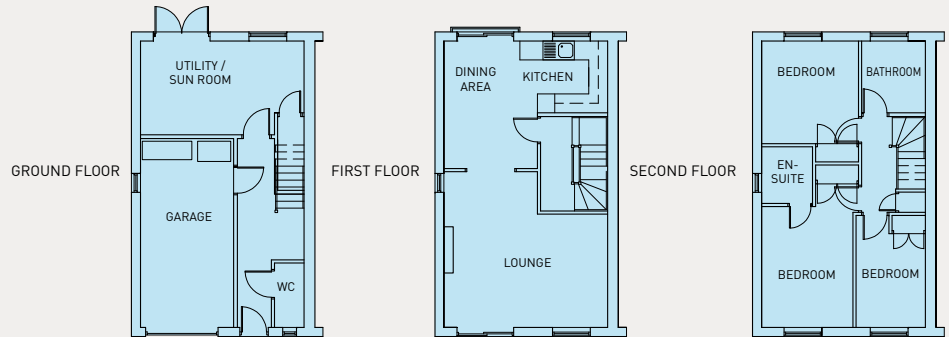

Horsefield

Houses

1, 3, 4, 8, 9, 15, 18, 20, 23, 24 & 28 on site plan

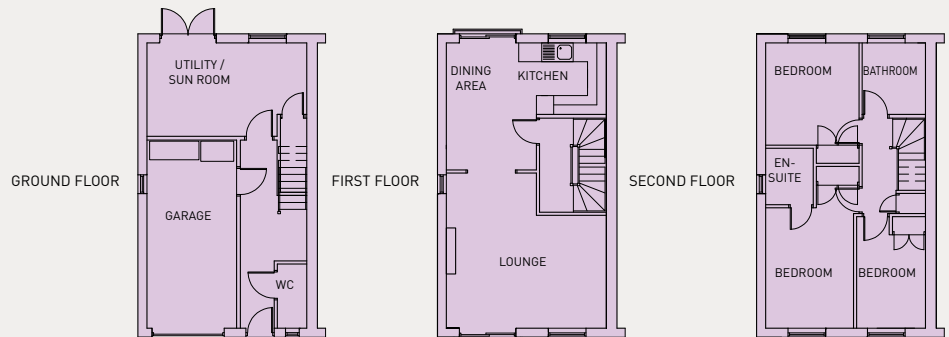

Note: Individual homes may have slight variations from those shown. Please ask for details on specific homes.

Site Plan



- HORSEFIELD
- STANDROYD
- BOULSWORTH

Conveniently located close to Lancashire's Hill Country and Pendle Hill



LOCATION

Standroyd Court is convenient for commuters to Manchester or Leeds, as well as the Yorkshire Dales and the market town of Skipton. The village of Barrowford and Colne town centre are within a short drive away.

The area also boasts some excellent opportunities for leisure activities, such as hiking, horse riding and mountain biking along the many paths and trails which meander through the surrounding countryside.

A development by:



Tel: 01282 442300
www.barnfieldhomes.co.uk



Tel: 01282 868686
www.petty.co.uk



MISREPRESENTATION ACT. Barnfield Homes for themselves and for the vendors or lessors of this property whose agents they are, give notice that (i) these particulars are produced in good faith, are set out as a general guide only and do not constitute any part of an offer or contract. They are believed to be correct but any intending purchasers or tenants should not rely on them as statements or representations of fact but must satisfy themselves as to the correctness of each of them. (ii) no person in the employment of Barnfield Homes has any authority to make or give any representation or warranty in relation to this property. 12/09

Created by www.concept4creative.com (ref 0985-09/10), an ISO9001 Quality and ISO14001 Environmental accredited company.